

■ **Specifications**

- Contact resistance: $\leq 20\text{m}\Omega$
- Insulation resistance: $\geq 500\text{M}\Omega$
- Rated voltage: 150V AC DC
- Rated current: 1.0A AC DC
- Withstand voltage: 500V AC/minute
- Temperature range: $-25^{\circ}\text{C} \sim +85^{\circ}\text{C}$

■ **Assembly Layout**

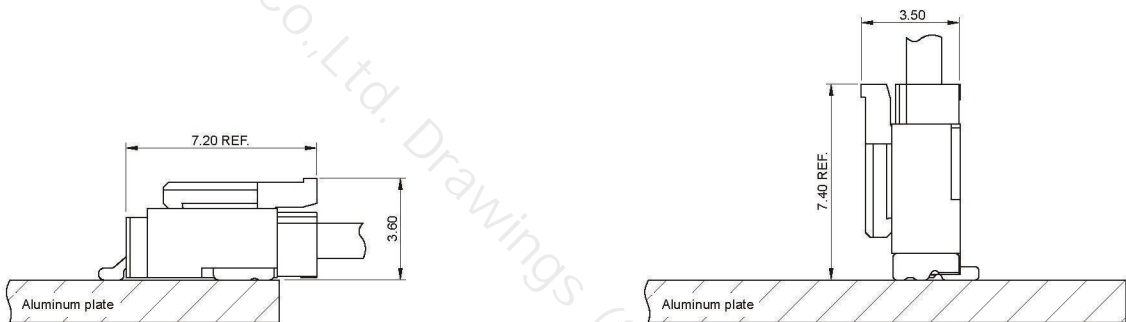

A1255AWR (1.25mm pitch 90°Wafer SMT TYPE)

- Reference Information:
- Material: Pin: Phosphor Bronze/Tin-plated
- Solder Tabs: Phosphor Bronze/Tin-plated
- Wafer: LCP,UL94V-0
- Mates with A1255 series Housing

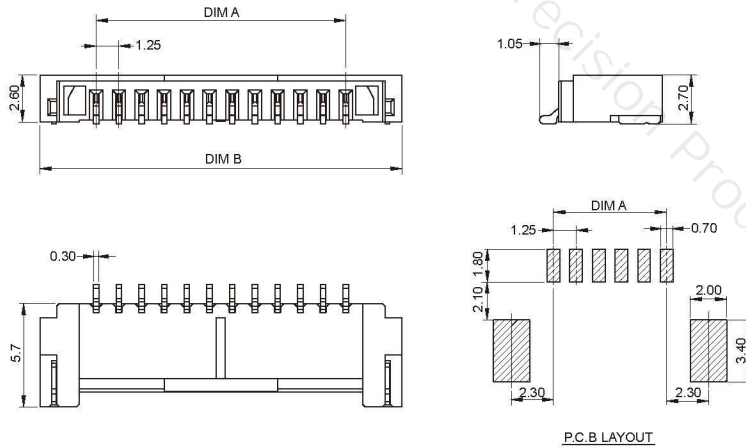
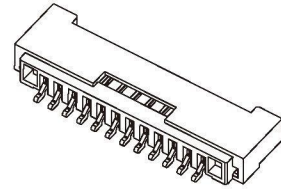

Ordering Information & Dimensions:

Circuit	Dimensions(mm)		Circuit	Dimensions(mm)	
	A	B		A	B
02	1.25	7.45	17	20.00	26.20
03	2.50	8.70	18	21.25	27.45
04	3.75	9.95	19	22.50	28.70
05	5.00	11.20	20	23.75	29.95
06	6.25	12.45	21	25.00	31.20
07	7.50	13.70	22	26.25	32.45
08	8.75	14.95	23	27.50	33.70
09	10.00	16.20	24	28.75	34.95
10	11.25	17.45	25	30.00	36.20
11	12.50	18.70	26	31.25	37.45
12	13.75	19.95	27	32.50	38.70
13	15.00	21.20	28	33.75	39.95
14	16.25	22.45	29	35.00	41.20
15	17.50	23.70	30	36.25	42.45
16	18.75	24.95			

A1255AWV (1.25mm pitch 180°Wafer SMT TYPE)

- Reference Information:
- Material: Pin: Phosphor Bronze/Tin-plated
- Solder Tabs: Phosphor Bronze/Tin-plated
- Wafer: LCP,UL94V-0
- Mates with A1255 series Housing

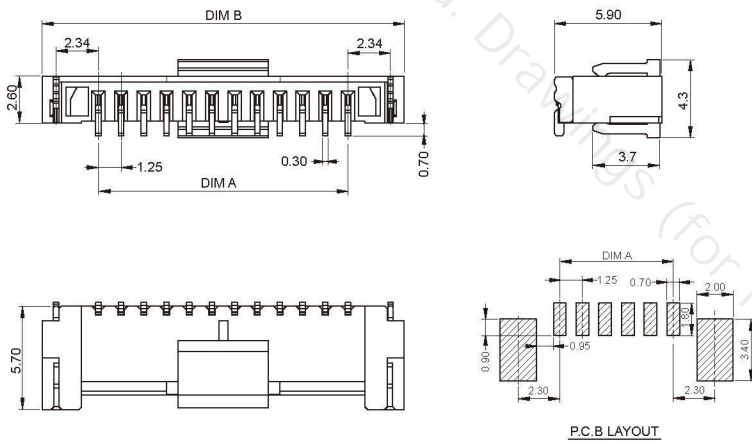
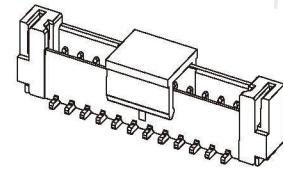

Ordering Information & Dimensions:

Circuit	Dimensions(mm)		Circuit	Dimensions(mm)	
	A	B		A	B
02	1.25	7.45	17	20.00	26.20
03	2.50	8.70	18	21.25	27.45
04	3.75	9.95	19	22.50	28.70
05	5.00	11.20	20	23.75	29.95
06	6.25	12.45	21	25.00	31.20
07	7.50	13.70	22	26.25	32.45
08	8.75	14.95	23	27.50	33.70
09	10.00	16.20	24	28.75	34.95
10	11.25	17.45	25	30.00	36.20
11	12.50	18.70	26	31.25	37.45
12	13.75	19.95	27	32.50	38.70
13	15.00	21.20	28	33.75	39.95
14	16.25	22.45	29	35.00	41.20
15	17.50	23.70	30	36.25	42.45
16	18.75	24.95			

WIRE TO BOARD
 BOARD TO BOARD
 WIRE TO WIRE
 FPC SERIES
 THRU SERIES
 LIGHTING SERIES
 OTHER SERIES

A1255Y (1.25mm pitch Housing)

Reference Information:

Material: PA66,UL94V-0(2)

Mates with A1255 series Wafer

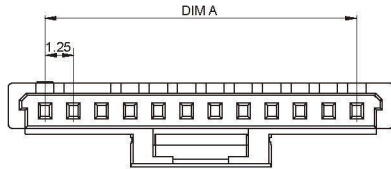
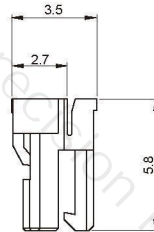
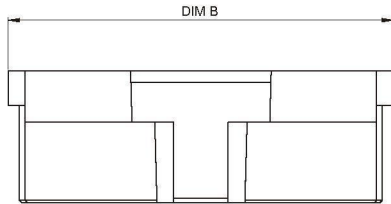
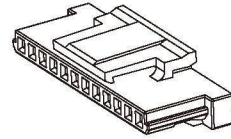

Ordering Information & Dimensions:

Circuit	Dimensions(mm)		Circuit	Dimensions(mm)	
	A	B		A	B
02	1.25	4.40	17	20.00	23.15
03	2.50	5.65	18	21.25	24.40
04	3.75	6.90	19	22.50	25.65
05	5.00	8.15	20	23.75	26.90
06	6.25	9.40	21	25.00	28.15
07	7.50	10.65	22	26.25	29.40
08	8.75	11.90	23	27.50	30.65
09	10.00	13.15	24	28.75	31.90
10	11.25	14.40	25	30.00	33.15
11	12.50	15.65	26	31.25	34.40
12	13.75	16.90	27	32.50	35.65
13	15.00	18.15	28	33.75	36.90
14	16.25	19.40	29	35.00	38.15
15	17.50	20.65	30	36.25	39.40
16	18.75	21.90			

A1255T (1.25mm pitch Terminal)

Reference Information:

Used in A1255 series Housing

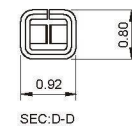
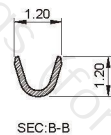
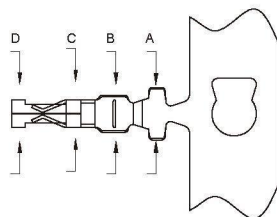
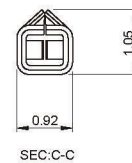
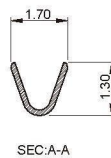
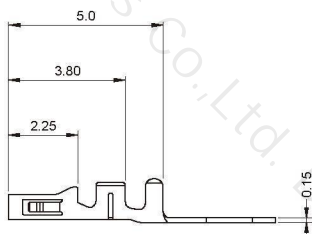

Ordering Information & Dimensions:

Part No	Wire Range	Insulation O.D.	Material	Finish	Qty/Reel
A1255T	AWG #28 ~ #32	1.00mm(max)	Phosphor bronze	Tin-plated	15000PCS