

■ Specifications

- Contact resistance: $\leq 30\text{m}\Omega$
- Insulation resistance: $\geq 500\text{M}\Omega$
- Rated voltage: 150V AC DC
- Rated current: 1.0A AC DC
- Withstand voltage: 500V AC/minute
- Temperature range: $-25^{\circ}\text{C} \sim +85^{\circ}\text{C}$

■ Assembly Layout

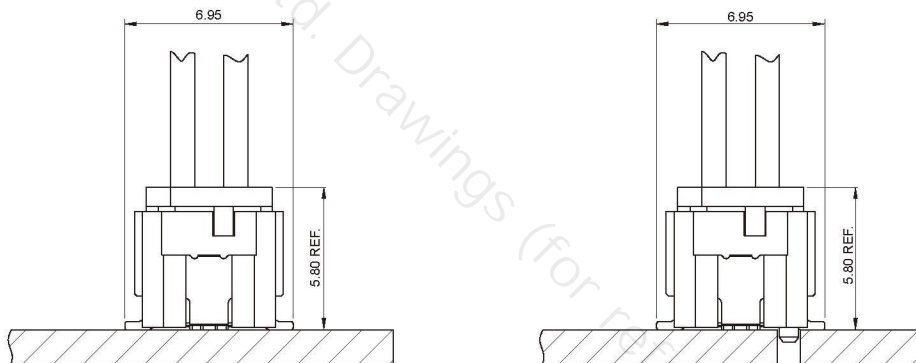

A1258AWV (1.25mm pitch 180°Wafer SMT TYPE)

- Reference Information:
 - Material: Pin: Brass/Tin-plated or Gold-Flash
 - SolderTabs: Brass/Tin-plated or Gold-Flash
 - Wafer: PA9T,UL94V-0
 - Mates with A1258 series Housing

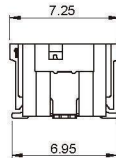
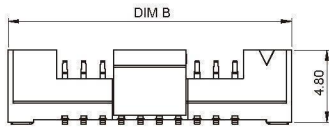
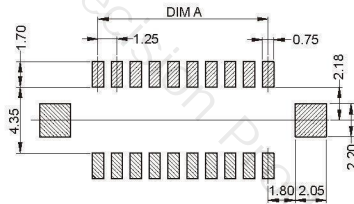
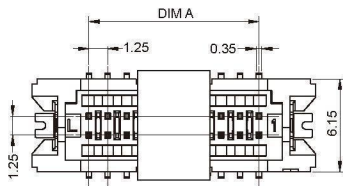
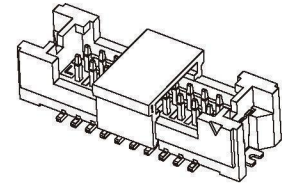

Ordering Information & Dimensions:

Circuit	Dimensions(mm)	
	A	B
2*5	5.00	12.50
2*10	11.25	18.75
2*15	17.50	25.00
2*20	23.75	31.25
2*25	30.00	37.50

A1258AWVB (1.25mm pitch 180°Wafer SMT TYPE)

- Reference Information:
 - Material: Pin: Brass/Tin-plated or Gold-Flash
 - SolderTabs: Brass/Tin-plated or Gold-Flash
 - Wafer: PA9T,UL94V-0
 - Mates with A1258 series Housing

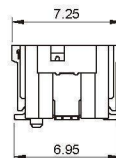
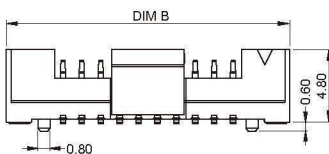
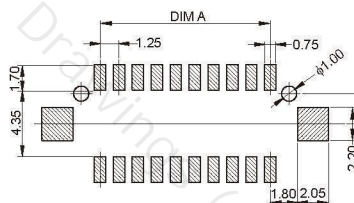
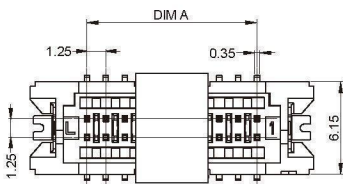
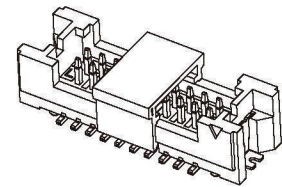

Ordering Information & Dimensions:

Circuit	Dimensions(mm)	
	A	B
2*5	5.00	12.50
2*10	11.25	18.75
2*15	17.50	25.00
2*20	23.75	31.25
2*25	30.00	37.50

A1258 SERIES

1.25mm pitch wire to board connector

A1258Y (1.25mm pitch Housing)

- Reference Information:
- Material: PA66, UL94V-0(2)
- Mates with A1258 series Wafer

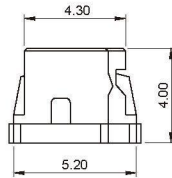
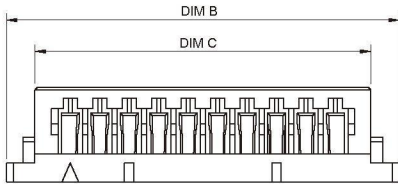
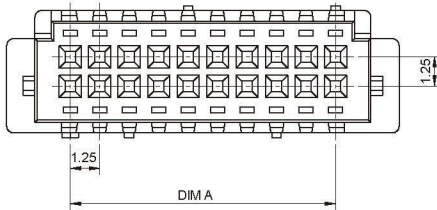
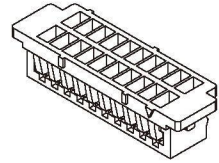

Ordering Information & Dimensions:

Circuit	Dimensions(mm)		
	A	B	C
2*5	5.00	10.40	8.00
2*10	11.25	16.65	14.25
2*15	17.50	22.90	20.50
2*20	23.75	29.15	26.75
2*25	30.00	35.40	33.00

A1258T (1.25mm pitch Terminal)

- Reference Information:
- Used in A1258 series Housing

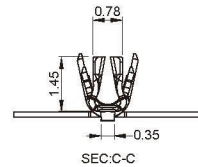
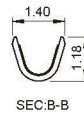
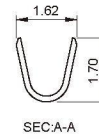
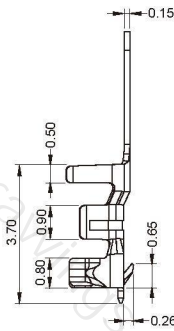
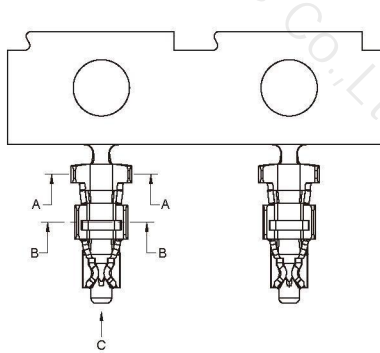

Ordering Information & Dimensions:

Part No	Wire Range	Insulation O.D.	Material	Finish	Qty/Reel
A1008T	AWG #26~#30	1.00mm(max)	Phosphor bronze	Tin-plated	10000PCS
A1008T-PC	AWG #26~#30	1.00mm(max)	Phosphor bronze	Gold-flash	10000PCS

WIRE TO BOARD

BOARD TO BOARD

WIRE TO WIRE

FPC SERIES

THR SERIES

LIGHTING SERIES

OTHER SERIES